

SYMBOLS KEY:

1. --- Valley
2. ○ Vent Pipes
3. --- Gutter (Remain)
4. // Flashing
5. --- Tie-In to Flat Roof
6. □ Sm Chimney 2' x 1.5'
7. □ Lg Chimney 4' x 1.5'

RDH Drawings
NOT for use by
other trades

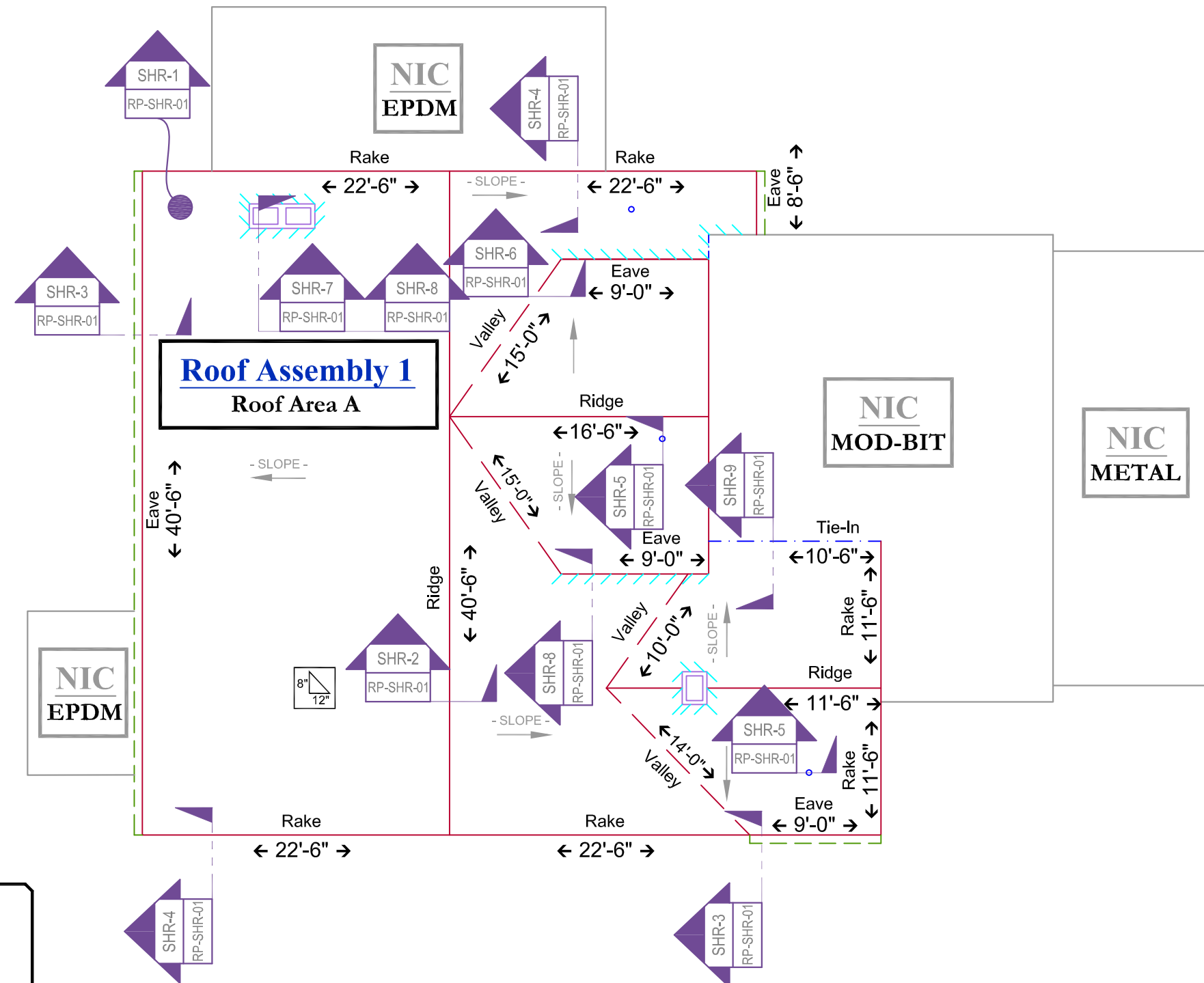

ROOF ASSEMBLY NOTES:

Assembly 1:

- > Wood Deck (existing)
- > Underlayment: 1 layer of **GAF Ice & Watershield Underlayment** at all valleys, walls & penetrations; self adhered; 1 Layer of **Generic #30 lb Felt** at entire field; mechanically attached.
- > Shingles: **GAF Timberline 30 yr Shingles** Color To be selected
- > Ridge Cap: **GAF Timbertex Shingles:** match field color

CONSTRUCTION NOTES:

1. Install new pre-fabricated boot flashings at all soil pipes.
2. Fabricate and install new 16 oz Copper Flashings at all walls & 2 Chimneys.
3. Gutters & Downspouts remain
4. No work to decking, siding, stucco, masonry or paint.

General Notes
& Revisions

RESIDENCE

-SHINGLE
RE-ROOF-

1010 Nolton Ave.
Nashville,
Tennessee
37204



RD Herbert & Sons
Roofing &
Sheet Metal

1407 3rd Avenue North
Nashville, TN 37208
Ph: 615-242-3501

www.rdherbert.com

- ROOF PLAN -

DRAWN BY: JLK	DATE: 12/5/08
APPROVED BY: H.HERBERT	PROJECT #: 08-0100
SCALE: 1/8" = 1'-0"	REVISION #: 00
ISSUED FOR: APPROVAL	

RP-SHR-01

SHEET 1 OF 1